

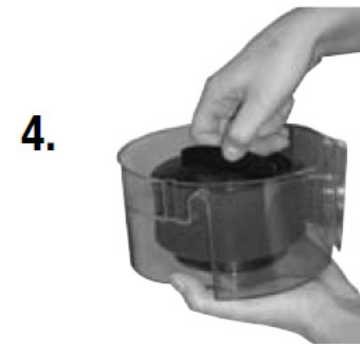

How to Clean Your Vacuum's Inner and Outer Circular Filter

BISSELL Part # 32R9

1. Unplug the cleaner from electrical outlet.
2. Remove the dirt container as described in the previous section. Grasp the filter cup located at the bottom of the dirt container, lift up and out. Do not try to pull circular foam filter out of the filter cup while it is still in the vacuum.
3. Grasp the plastic tab on the top of the circular foam filters. Twist to unlock and pull out.
4. Separate the outer foam and inner pleated circular filters. Wash each individually by hand in warm water. Mild detergent may be used if desired. Rinse well, then air dry thoroughly before putting them back together and replacing in filter cup.
5. The filter cup may be washed in warm water with a mild detergent. Make sure it is completely dry before reassembling with filters.
6. The upper tank and louvers may also be wiped clean with a damp cloth. Reach underneath the upper tank and turn the rim of the louvers to unlock. Pull straight down to remove. Make sure all parts are dry before replacing.

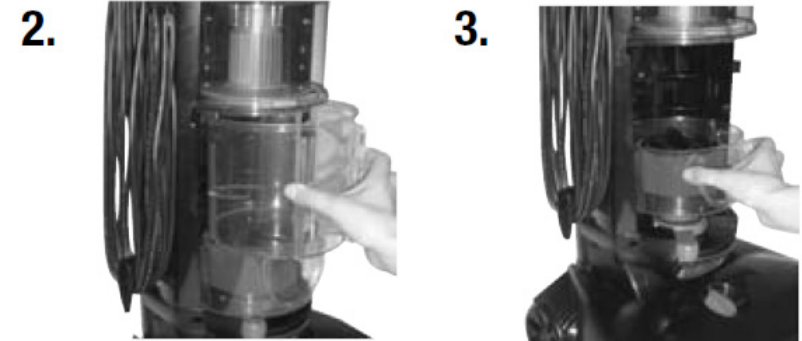

Need help?

Call:

1-800-237-7691

Mon-Fri: 8am to 10pm ET

Sat: 9am to 8pm ET

Visit:

www.bissell.com/contact-us