



How to Remove and Replace Your Carpet Deep Cleaner's Brush Belt - Non-Corded (smaller)

BISSELL Part # 203-6688



1. Turn off the machine and unplug it from the outlet.
2. Remove both the 2-in-1 water tank and the formula tank. Set aside.
3. Unscrew the front nozzle and remove it. Set aside.
4. Turn the machine on its side. **IMPORTANT:** cord side down
5. Remove the clear end cap by unscrewing the 2 black screws. Take care not to drop the screws into the unit.
6. Remove one silver screw.
7. Remove pivot arm by gently lifting up.
8. Remove small brush belt.
9. Replace small brush belt and reverse steps above.

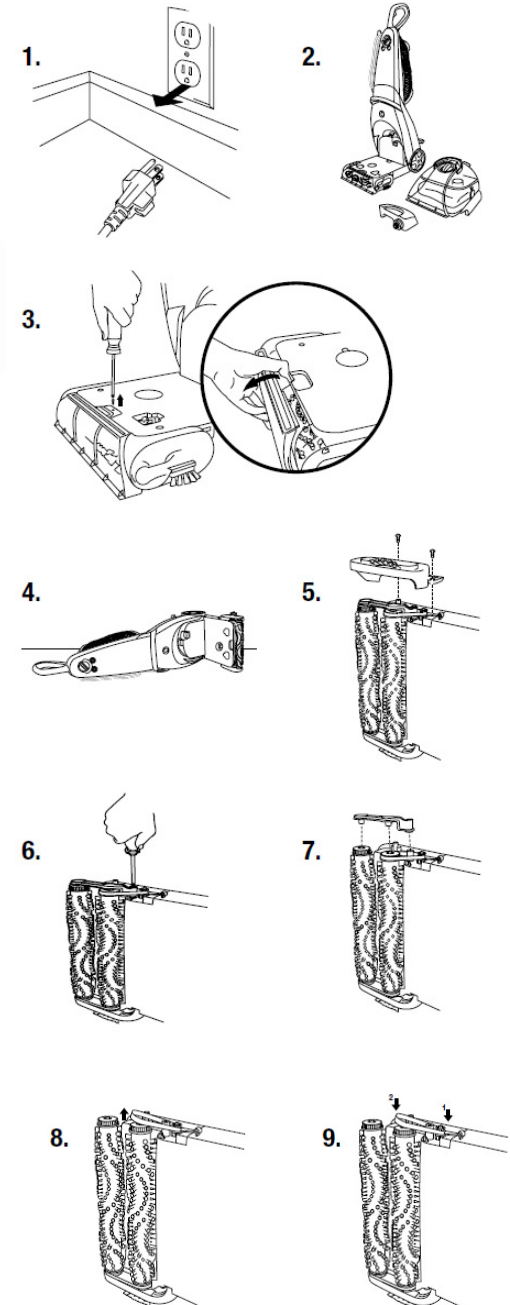

Need help?

Call:

1-800-237-7691

Mon-Fri: 8am to 10pm ET

Sat: 9am to 8pm ET

Visit:

www.bissell.com/contact-us

To help keep your product running its best, purchase genuine parts and accessories directly from BISSELL.

www.bissell.com